

BK9082 Installation

Recommended for Indoor Installation only. Intended to be wall mounted.

Scoreboard MUST be mounted in at least 4 points. Scoreboard will have mounting holes in each corner of the board. If more mounting points are required, drill new mounting points through the supplied flange.

Using lifting angle lift scoreboard to desired location and bolt to wall. Because wall types may vary, type of bolt cannot be recommended nor supplied by All American Scoreboards. Refer to scoreboard weight and wall type before determining installation method. In rare cases, additional structure may be necessary. All American Scoreboards (AAS) and/or Everbrite, LLC shall not be held liable for improper installation.

AAS recommends the scoreboard be installed by a licensed contractor, and must meet all local and national building codes. AAS recommends using a boom, forklift, or crane of suitable size to use in installation.

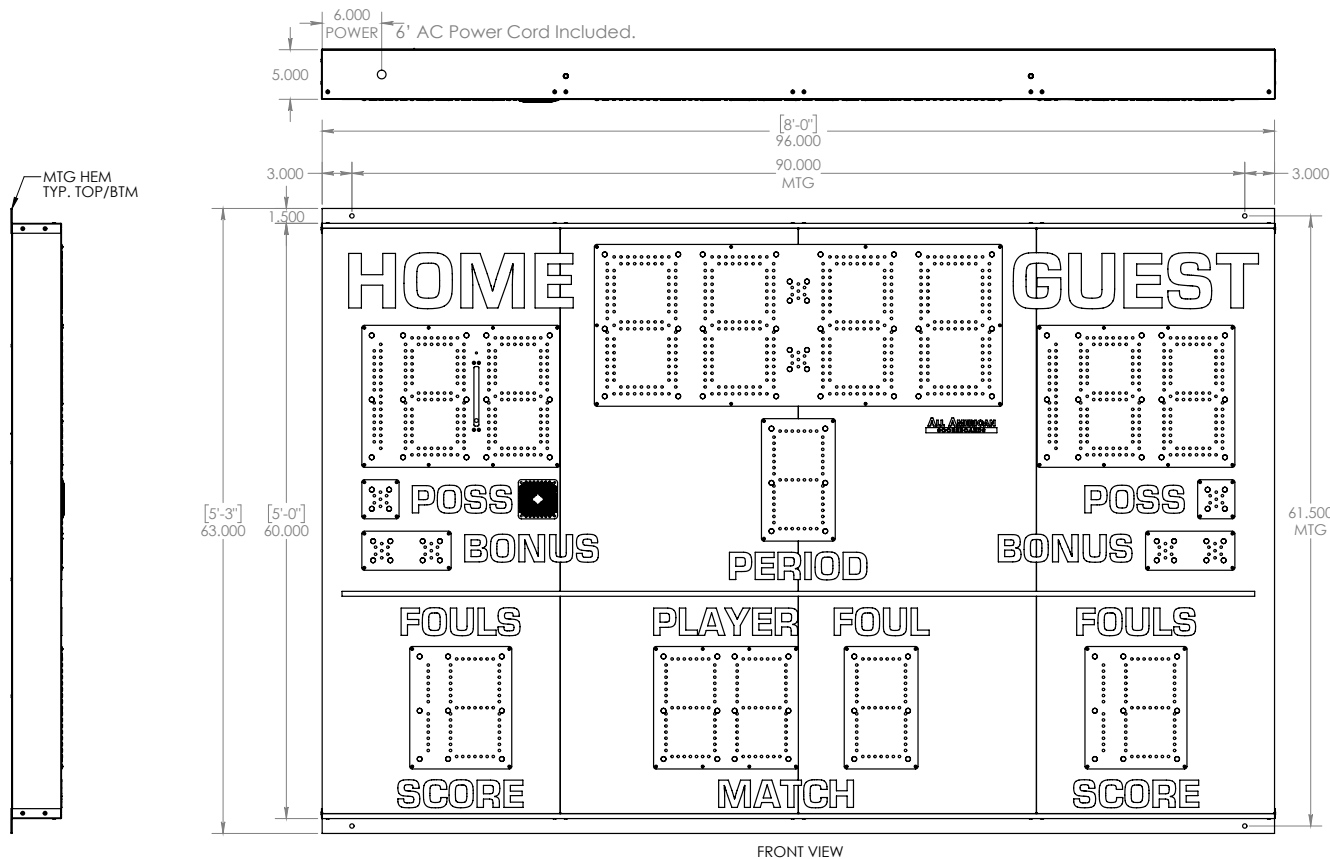

SCOREBOARD SPECIFICATIONS

- OVERALL DIMENSIONS OF SIGN:
HEIGHT: 60.000"
WIDTH: 96.000"
DEPTH: 5.000"
EST. WEIGHT: 164.204
- AREA OF SIGN - SQUARED: 40.0 SQ.FT.
- POWER SUPPLY: (2) 24V / 96W POWER SUPPLIES
INPUT: 120 VAC 1.86 AMPS
OUTPUT: 24VDC 96 WATTS MAX
- (1) 20 AMP CIRCUIT, 60Hz UL 48 & NEC COMPLIANT
- SIGN IS TO BE MANUFACTURED TO UL 48 SPECIFICATIONS.
- MAXIMUM DESIGN WINDLOAD: 35 PSF
- SIGN WILL BE SERVICEABLE BY REMOVING THE HOME SCORE FACE TO ACCESS ELECTRICAL COMPONENTS.

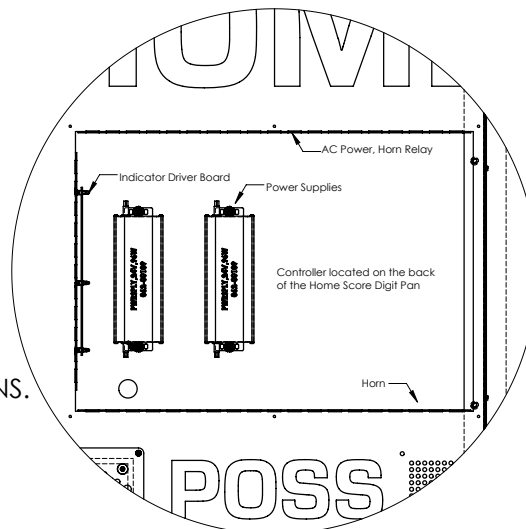

WITH DIGIT PANEL REMOVED FOR CLARITY