

REVISIONS			
REV.	DESCRIPTION	DATE	APPROVED
A	RELEASED FOR SPEC	6/20/2019	TJL

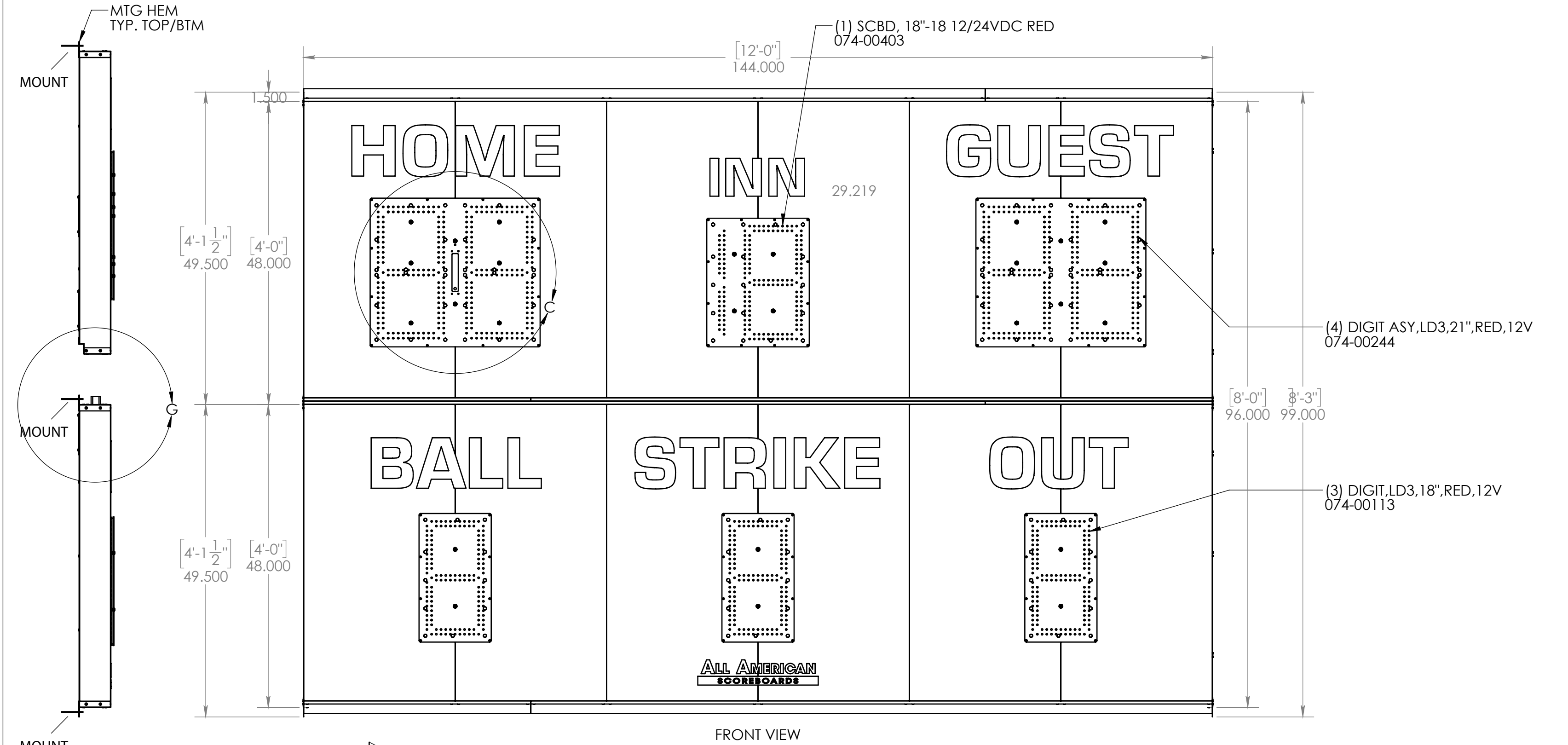

2 cable harnesses with locking connectors will be required to connect top board to bottom board. This connection is required as the top board is being lowered down to the bottom board.

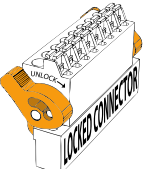

AC connection is at back of board. The power box (supplied by others) can be mounted to either knockout on plate, which was designed to allow flexibility when poles are positioned where the power is routed.

The power inlet is typically on the back opposite of the HOME score

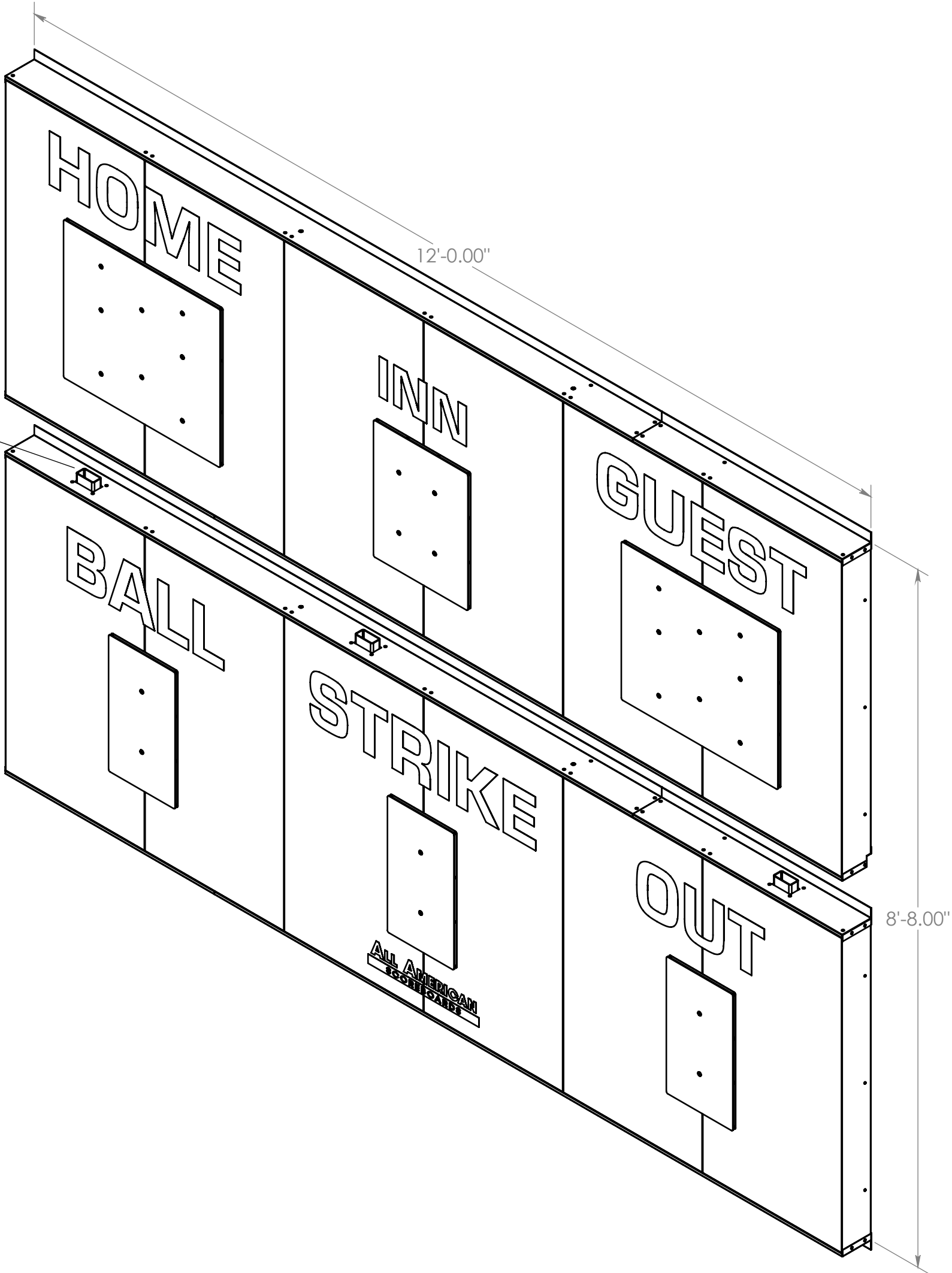

**OPTION B -  
NON-STANDARD - ADDITIONAL PARTS REQUIRED  
PART KT07514 (per mounting point)**

**OPTION A - INCLUDED**  
STEEL BAR BACKED BOLTS  
DIRECTLY DRILLED INTO I-  
BEAM AND BACKED WITH  
NUTS.

STEEL BAR BACKED  
THREADED ROD GOING  
AROUND I-BEAM AND  
BACKED WITH UNISTRUT  
(OR OTHER STRUCTURAL  
MEMBER) ON BACK SIDE  
OF I-BEAM AND FASTENED  
WITH WASHERS AND NUTS

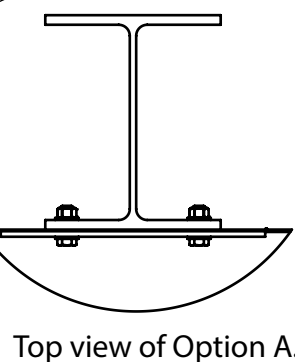

FRONT OF SCOREBOARD  
DIGITS AND VINYL NOT SHOWN

TYPICAL POLE/I-BEM SET UP

DETAIL L

STANDARD KIT, MTG FOR OD 9000 SCBDS  
050-00201 6 REQ

ATTENTION: STEEL BAR REQUIRED FOR STRUCTURAL INTEGRITY.

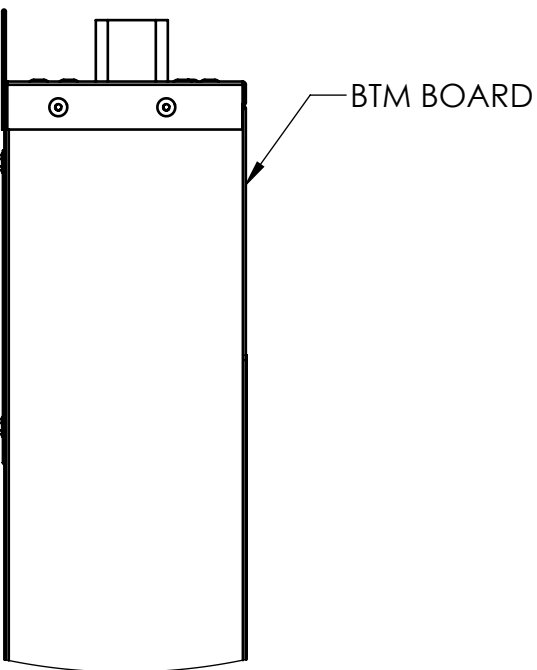
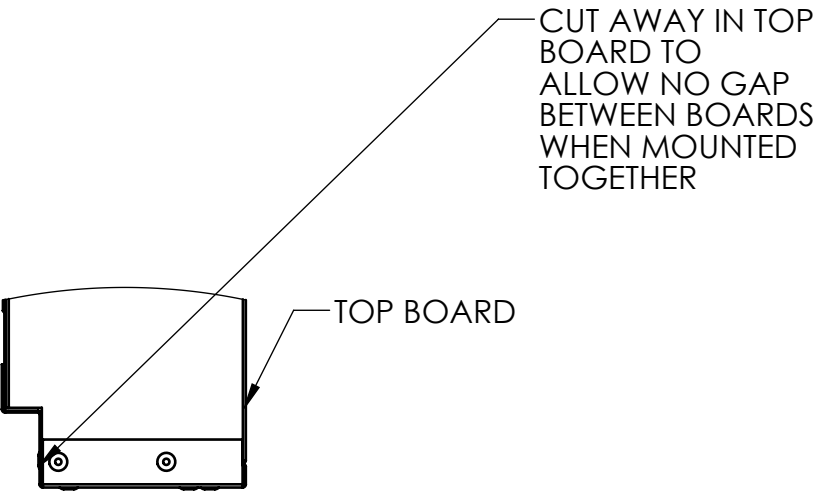

DETAIL G  
SCALE 1 : 4

ALL WIRING AND ELECTRICAL  
CONNECTIONS ON THIS DISPLAY  
MUST BE INSTALLED IN ACCORDANCE  
WITH THE REQUIREMENTS OF ARTICLE  
600 OF THE NATIONAL ELECTRICAL CODES  
AND/OR OTHER APPLICABLE LOCAL CODES.  
THIS INCLUDES PROPER GROUNDING AND  
BONDING OF THE DISPLAY.

SCOREBOARD SPECIFICATIONS

- OVERALL DIMENSIONS OF SIGN:  
HEIGHT: 96.000 "  
WIDTH: 144.000 "  
DEPTH: 5.000 "  
EST. WEIGHT: 380.523
- AREA OF SIGN - SQUARED: 96.0 SQ.FT.
- POWER SUPPLY: (1) 24V / 96W POWER SUPPLIES  
INPUT: 100-277 VAC @ 1.2 AMPS  
OUTPUT: 24VDC 96 WATTS MAX
- (1) 20 AMP CIRCUIT, 60Hz UL 48 & NEC COMPLIANT
- SIGN IS TO BE MANUFACTURED TO UL 48 SPECIFICATIONS.
- MAXIMUM DESIGN WINDLOAD: 35 PSF
- SIGN WILL BE SERVICEABLE BY REMOVING THE HOME  
SCORE FACE TO ACCESS ELECTRICAL COMPONENTS.

Installation Instructions			
ORD	ITEM	FILE	
<div><div></div><div>401 South Main St. P.O. Box 100 Pardeeville, WI. 53954 608-429-2121</div></div> <div>These drawings are the exclusive property of Everbrite, Inc. Use of, or duplication in any manner without express written permission of Everbrite, Inc. is prohibited.</div>			
TITLE BA9126			
DRN	DT	SCALE	DRWG NR
CRD	DT		REV A